

APPENDIX A

31/01/2018

Business - Application for a premises licence to be granted under the Licensing Act 2003
Ref No. 965383

Name of Applicant

Please enter the name(s) who is applying for a premises licence under section 17 of the Licensing Act 2003 and am making this application to you as the relevant licensing authority in accordance with section 12 of the Licensing Act 2003

	Greenpoint Avenue Limited
--	---------------------------

Premises Details

Non-domestic rateable value of premises in order to see your rateable value click here (opens in new window)

£	20500
	Band D and E only applies to premises which uses exclusively or primarily for the supply of alcohol for consumption on the premises
	No

Premises trading name

	Theo's
--	--------

Postal address of premises or, if none, ordnance survey map reference or description

Address Line 1	17 - 19 ELEPHANT & CASTLE
Address Line 2	
Town	LONDON
County	
Post code	
Ordnance survey map reference	SE1 6TH
Description of the location	
Telephone number	

Applicant Details

Please select whether you are applying for a premises licence as Please tick as appropriate

	<input type="checkbox"/> a person other than an individual (limited company, partnership, etc)
--	--

Business - Application for a premises licence to be granted under the Licensing Act 2003

If you are applying as an individual or sole trader please select one of the following:

☒ I am carrying on or proposing to carry on a business which involves the use of the premises for licensable activities

Other Applicants:

Personal Details - First Entry

Name

Sigurd Haver

17/06/2007

0700 000 000

10607736

Address - First Entry

Street number or building name

5

Street Description

Willem Bridge Road

Town

Londen

County

Post code

NP23 5

Registered number (where applicable)

Description of applicant (for example, partnership, company, unincorporated association etc.)

Greenport Avonport Limited Company Number: 1330736

17/06/2007

Contact Details - First Entry

Telephone number

Email address

Operating Schedule

When do you want the premises licence to start?

01/05/2010

If you wish the licence to be valid only for a limited period, when do you want it to end?

General description of premises (see guidance note 1)

Business - Application for a premises licence to be granted under the Licensing Act 2003

	Pizza restaurant
--	------------------

Please select the range of the number of people expected to attend the premises at any one time.

	Less than 5000
If 5,000 or more people are expected to attend the premises at any one time. Please state the number expected to attend	

Operating Schedule part 2

What licensable activities do you intend to carry on from the premises?

	(Please see sections 1 and 14 of the Licensing Act 2003 and schedule 1 and 2 to the Licensing Act 2003)
--	---

Provision of regulated entertainment (Please read guidance note 2)

	f) recorded music

Provision of late night refreshment

	i) Late night refreshment
--	---------------------------

Supply of alcohol

	j) Supply of alcohol
--	----------------------

F - Recorded Music

Will the playing of recorded music take place indoors or outdoors or both? (Please read guidance note 3)

	Indoors
--	---------

Business - Application for a premises licence to be granted under the Licensing Act 2003

Please give further details here (Please read guidance note 4)

	Seated pizza restaurant background music
--	--

Standard days and timings for Recorded Music (Please read guidance note 7)

Day	Start	Finish
Mon	10:00	00:30
Tues	10:00	00:30
Wed	10:00	00:30
Thur	10:00	00:30
Fri	10:00	00:30
Sat	10:00	00:30
Sun	10:00	00:30

State any seasonal variations for playing recorded music (Please read guidance note 5)

--	--

Non standard timings. Where you intend to use the premises for the playing of recorded music entertainment at different times to those listed. (Please read guidance note 6)

--	--

I - Late Night Refreshment

Will the provision of late night refreshment take place indoors or outdoors or both? (Please read guidance note 2)

	Both
--	------

Please give further details here (Please read guidance note 3)

	Seated dining
--	---------------

Standard days & timings for Late night refreshment (Late night start time is from 23.00, see guidance notes 6)

Day	Start	Finish
Mon	23:00	00:30
Tues	23:00	00:30
Wed	23:00	00:30
Thur	23:00	00:30

Business - Application for a premises licence to be granted under the Licensing Act 2003

Fri	23:00	00:30
Sat	23:00	00:30
Sun	23:00	00:30

State any seasonal variations for the provision of late night refreshment (Please read guidance note 4)

--	--

Non standard timings. Where you intend to use the premises for the provision of late night refreshment at different times, to those listed. Please list, (Please read guidance note 5)

--	--

J - Supply of Alcohol

Will the supply of alcohol be for consumption (Please read guidance note 8)

	Both
--	------

Standard days and timings for Supply of alcohol (Please read guidance note 7)

Day	Start	Finish
Mon	12:00	00:00
Tues	12:00	00:00
Wed	12:00	00:00
Thur	12:00	00:00
Fri	12:00	00:00
Sat	12:00	00:00
Sun	12:00	00:00

State any seasonal variations for the supply of alcohol (Please read guidance note 5)

--	--

Non standard timings. Where you intend to use the premises for the supply of alcohol at different times to those listed. Please list, (Please read guidance note 6)

--	--

Please upload the consent form completed by the proposed premises supervisor

	20180131162408874.pdf
--	-----------------------

Business - Application for a premises licence to be granted under the Licensing Act 2003

Premises Supervisor

Full name of proposed designated premises supervisor

First names	Theo
Surname	Lewis

DOB

Date Of Birth	
---------------	--

Address of proposed designated premises supervisor

Street number or Building name	
Street Description	
Town	
County	
Post code	

Personal licence number of proposed designated premises supervisor, if any,

Personal licence number (if known)	
Issuing authority (if known)	

K

Please highlight any adult entertainment or services, activities, other entertainment or matters ancillary to the use of the premises that may give rise to concern in respect of children (Please read guidance note 9)

	None
--	------

L - Hours premises are open to public

Hours premises are open to the public (standard timings Please read guidance note 7)

Day	Start	Finish
Mon	07:00	00:30
Tues	07:00	00:30
Wed	07:00	00:30
Thur	07:00	00:30
Fri	07:00	00:30

Business - Application for a premises licence to be granted under the Licensing Act 2003

Sat	07:00	00:30
Sun	07:00	00:30

State any seasonal variations (Please read guidance note 5)

--	--

Non standard timings. Where you intend to use the premises to be open to the public at different times from those listed. Please list, (Please read guidance note 6)

--	--

M - Steps to promote four licencing objectives

a) General - all four licensing objectives (b,c,d,e) (Please read guidance note 10)

	<p>1. The premises' staff will be trained to understand the responsibility attached to the supply of alcoholic drinks and that alcoholic drinks shall be limited to beer wine may be served to and consumed by persons aged 16 or 17 only if they are accompanied by persons over the age of 18 and consuming substantial food while sitting at a table.</p> <p>2. No alcoholic drinks will be served to persons under 16 years of age, even when with adults, and no provision of any alcoholic drinks will be to unaccompanied persons under 18 years of age.</p> <p>3. The premises shall operate an agecheck 'Challenge 25' policy whereby customers purchasing alcohol who look or appear to be under 25 years of age will be asked for an approved form of proof of age to verify their age. Approved forms shall include a driving licence, passport or a PASS approved proof of age card such as the Southwark Proof of Age (SPA) card.</p> <p>4. All staff involved in the sale of alcohol shall before doing so, receive training which will include legal requirements as to the supply of alcohol to people. This shall include training in the agecheck 'Challenge 25' policy. A record of their training, for each member of such staff shall be maintained and be available for inspection at the premises on request by the council's authorised officers or the police.</p> <p>5. Agecheck or 'Challenge 25' signage shall be displayed at entrances to the premises, areas where alcohol is displayed for sale and at points of sale to inform customers that an agecheck 'Challenge 25' policy applies and proof of age may be required.</p> <p>6. A register of refused sales of alcohol sales which is clearly marked with details of the premises, address and name of licence holder shall be maintained in order to demonstrate effective operation of the policy. The register shall be available for inspection at the premises on request by the council's authorised officers or the police.</p> <p>7. The premises shall not hold licensed entertainment unless approved under a temporary events notice.</p> <p>8. The premises licence holder shall display a telephone number for local residents to contact management of the premises as and when necessary.</p> <p>9. No alcohol or beverages shall be taken out of the premises at any time by diners seated inside the restaurant</p> <p>10. All off sales of alcohol shall be made in sealed containers and shall be for consumption away from the premises.</p> <p>11. No off sales of alcohol shall be made between the hours of 23:00 to 12:00</p> <p>12. The premises may be open Monday to Saturday between 07:00 to 00:30</p> <p>13. External tables and chairs will be stacked and secured in such a way as to discourage their use after closure of the premises.</p> <p>14. The premises shall install and maintain a comprehensive CCTV system, with all entry and exit points being covered, enabling clear facial image identification of every person entering in any light condition. The CCTV system shall continually record whilst the premises is open for licensable activities and during all times when customers remain on the premises. All recordings shall be stored for a minimum period of 31 days, with date and time stamping. Viewing of the recordings shall be made available upon the reasonable request of the Police or authorised Council officer throughout the entire 31 day period (subject to any obligations under the Data Protection Act 1998).</p>
--	--

	<p>15. A staff member from the premises who is conversant with the operation of the CCTV system must be able to provide a Police or authorised Council officer copies of recent CCTV images or data with the absolute minimum of delay.</p> <p>16. The maximum external capacity will be limited to 50.</p> <p>17. The external area will be out of use between 23:00 and 08:00, with all furniture having been brought into the premises or, if left outside, rendered unusable.</p> <p>18. The premises will use its best endeavours to ensure that any moving of outside furniture and barriers is done in a quiet and orderly fashion.</p> <p>19. Between 23:00 and 08:00, no alcoholic drinks sold or supplied by the premises shall be permitted to be consumed in the external area outside the premises.</p> <p>20. After 22:00, customers permitted to temporarily leave and then re-enter the premises to smoke must be directed to stand more than 15 feet away from the premises.</p> <p>21. No external areas of the premises, including the external frontage area, shall be used for the purposes of regulated entertainment.</p> <p>22. Amplified music, song or speech shall not be broadcast in external areas</p> <p>23. Deliveries, collections and external cleaning shall not occur between 18:00 and 08:00</p> <p>24. Any external plant such as the kitchen extraction system, condensers, etc will not operate between 00:00 - 08:00 and shall have a noise output that does not exceed 10 dB (A) below the lowest L90 15 min relevant in the period the plant will be operational.</p> <p>25. All escape routes and external exits shall be maintained unobstructed, in good order with non-slippery and even surfaces, free of trip hazards and clearly identified in accordance with the approved arrangements. All exits door shall be available and easily operable without the use of a key, card, code or similar means. Any removable security fastening shall be removed from the doors prior to opening the premises to the public. All such fastenings shall be kept in the approved positions. d.If required, exit doors shall be secured in the fully open position when the public are present. All fire-doors shall be maintained effectively self-closing and shall not be held open other than by approved devices. Fire-resisting doors to ducts, service shafts and cupboards shall be kept locked shut. The edges of treads of steps and stairways shall be maintained so as to be conspicuous.</p> <p>26. Notices detailing the actions to be taken in the event of fire or other emergencies, including how the fire brigade can be summoned, shall be prominently displayed and shall be protected from damage or deterioration.</p>
--	--

b) the prevention of crime and disorder

	See above
--	-----------

c) public safety

	See above
--	-----------

d) the prevention of public nuisance

	See above
--	-----------

e) the protection of children from harm

	See above
--	-----------

Please upload a plan of the premises

	Scan-2018-1-31-17.04.22.pdf
--	---

Business - Application for a premises licence to be granted under the Licensing Act 2003

Please upload any additional information i.e. risk assessments

--	--

Checklist

	I have enclosed the plan of the premises. I understand that if I do not comply with the above requirements my application will be rejected. I understand that I must now advertise my application (In the local paper within 14 days of applying)
--	---

Home Office Declaration

Please tick to indicate agreement

	I am a company or limited liability partnership
--	---

Declaration

I agree to the above statement

	Yes
PaymentDescription	
AuthCode	616930
LicenceReference	ks102 94212
PaymentContactEmail	

The information you provide will be used fairly and lawfully and Southwark Council will not knowingly do anything which may lead to a breach of the Data Protection Act 1998.

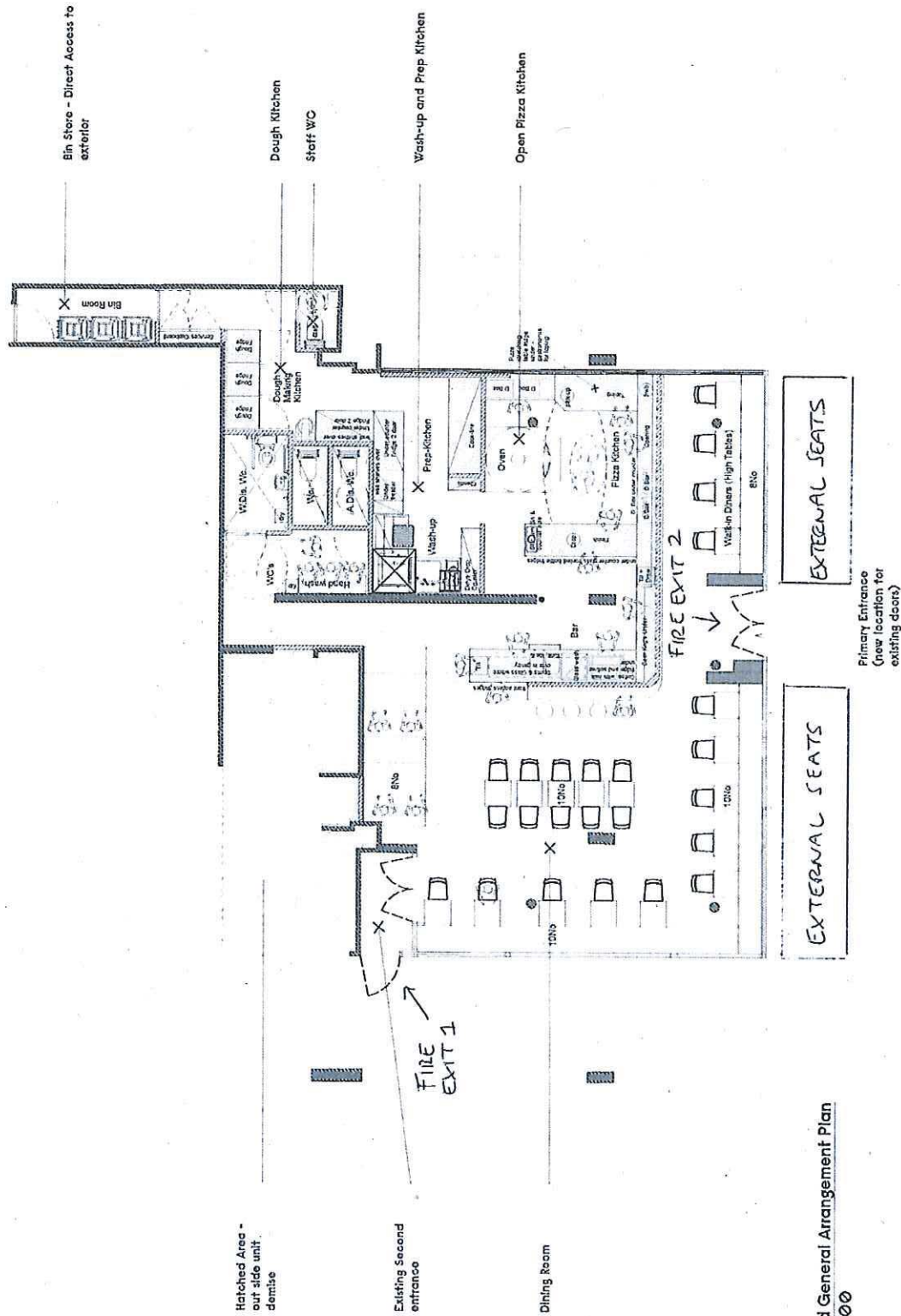

1 Proposed General Arrangement Plan
Scale: 1:100



Revision	Date	Description
A	12/12/17	Notes Added

Gundry + Ducker
 Gundry + Ducker Architects Ltd
 35 South Street
 London EC1A 3DF
 Tel: 020 7460 1234
 Email: info@gundryducker.com

Project: Theatrical
 Drawing Title: General Arrangement
 Scale: 1:100 @ A3
 Date: April 2017
 Status: Information Only

This drawing is the property of Gundry + Ducker Architects Ltd and is not to be reproduced without permission.